

**Legend**

- SUE Boundary
- Indicative Structural Green Space associated with SUE
- Northampton Related Development Area
- District Boundary
- Mineral Safeguarding Sand & Gravel
- Flood Zone 2
- Flood Zone 3

**Note**  
 "For further details about the Minerals Safeguarding Areas see the Northamptonshire MWDF Core Strategy DPD (Adopted May 2010)"



Name: **INSET 7**  
 Date: **July 2012**  
 Scale: **1:7000 @ A4**  
 Dept: **JPU**  
 Project: **Proposal Maps Rev**

**Title**  
**INSET 7 - Northampton West SUE (Policy N4)**

Produced from the 2009 Ordnance Survey mapping with the permission of the Controller of Her Majesty's Stationery Office. © Crown Copyright. Unauthorised reproduction infringes Crown Copyright and may lead to prosecution or civil proceedings. Licence number: 100019655



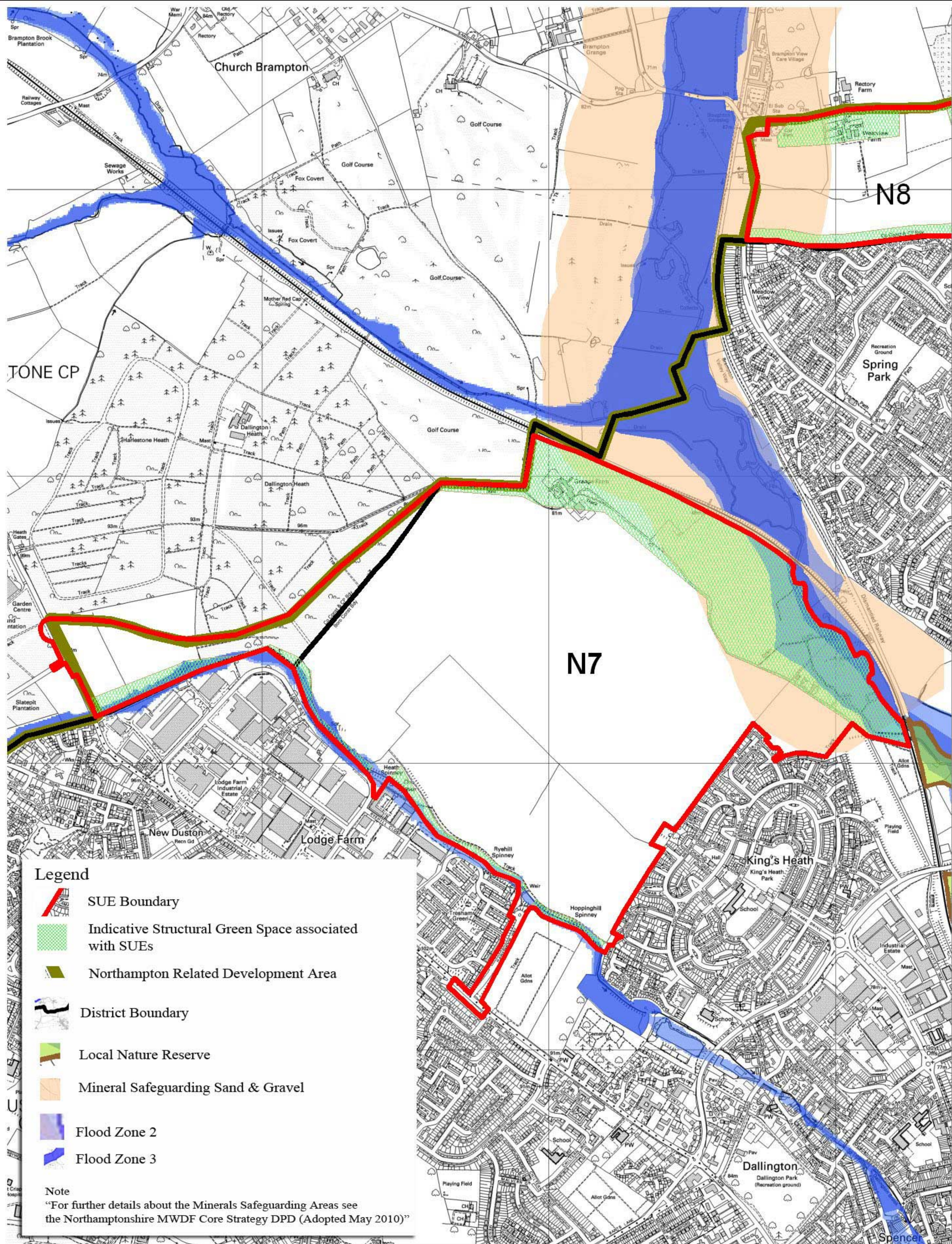

**Name:** INSET 8  
**Date:** July 2012  
**Scale:** 1:16000 @ A4  
**Dept:** JPU  
**Project:** Proposal Maps Rev





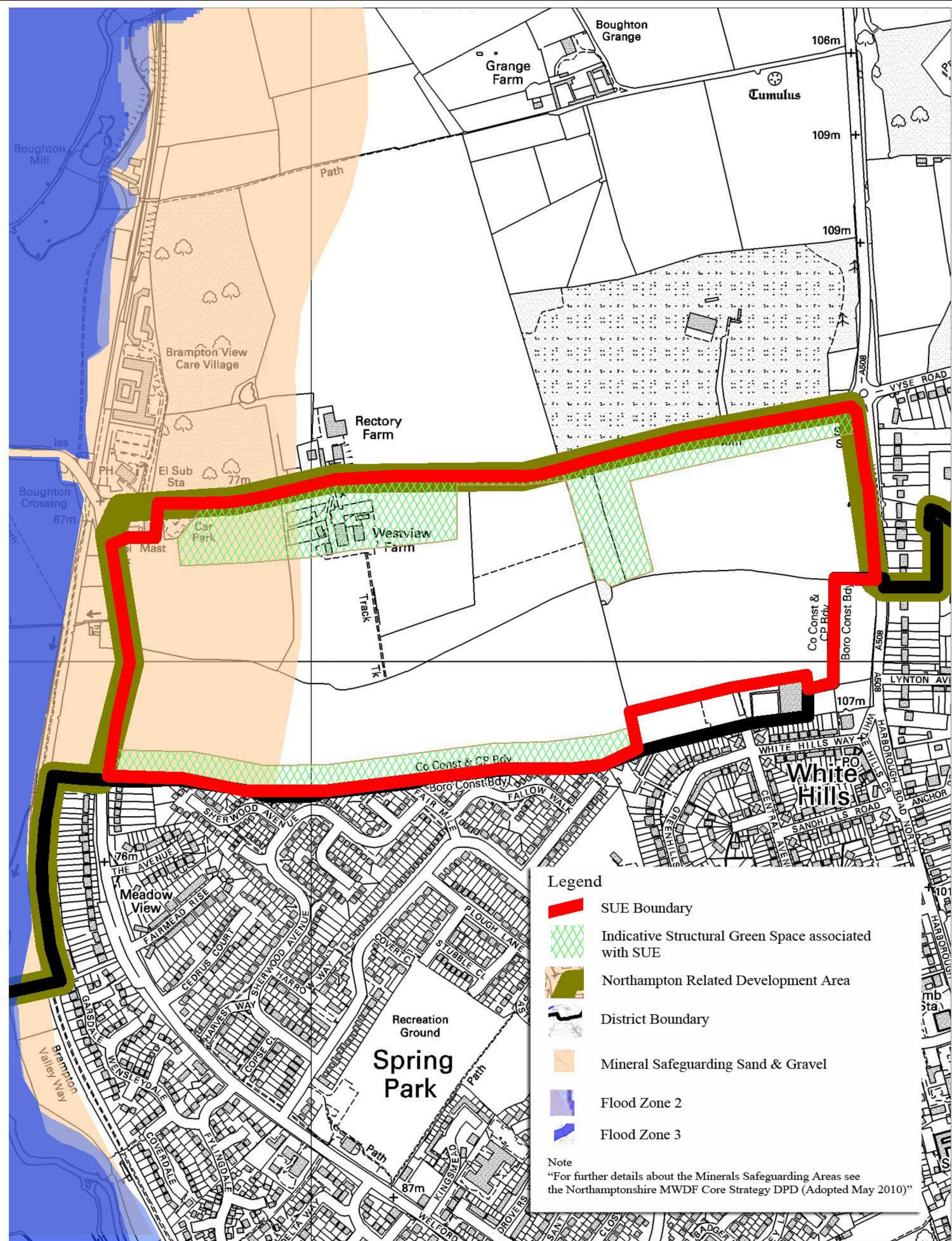

**Title**  
**INSET 8 - Northampton Kings Heath SUE (Policy N7)**

Produced from the 2009 Ordnance Survey mapping with the permission of the Controller of Her Majesty's Stationery Office. © Crown Copyright. Unauthorised reproduction infringes Crown Copyright and may lead to prosecution or civil proceedings. Licence number: 100019655





**Legend**

-  SUE Boundary
-  Indicative Structural Green Space associated with SUE
-  Northampton Related Development Area
-  District Boundary
-  Mineral Safeguarding Sand & Gravel
-  Flood Zone 2
-  Flood Zone 3

**Note**  
 "For further details about the Minerals Safeguarding Areas see the Northamptonshire MWDF Core Strategy DPD (Adopted May 2010)"



Name: INSET 9  
 Date: July 2012  
 Scale: 1:7000 @ A4  
 Dept: JPU  
 Project: Proposal Maps Rev

**Title**  
**INSET 9 - Northampton North of Whitehills SUE (Policy N8)**

Produced from the 2009 Ordnance Survey mapping with the permission of the Controller of Her Majesty's Stationery Office. © Crown Copyright. Unauthorised reproduction infringes Crown Copyright and may lead to prosecution or civil proceedings. Licence number: 100019655